



文化でつながる。未来とつながる。
THE FUTURE IS ART

TokyoTokyo
FESTIVAL

PAVILION
TOKYO
2021

May 26, 2021

Arts Council Tokyo (Tokyo Metropolitan Foundation for History and Culture)
Executive Committee of Pavilion Tokyo 2021

Tokyo Tokyo FESTIVAL Special 13
PAVILION TOKYO 2021

Announces 6 additional venues

In front of United Nations University / In front of the former "National Children's Castle" /
Yoyogi Park (near Panorama Grass Field) / Garden of kudan house /
Hama-rikyu Gardens (Site of Enryo-kan) / Takanawa Gateway Station (inside the ticket gate)

Daito Manabe + Rhizomatiks to participate

to install the latest work "2020-2021"

Related event "PAVILION TOKYO 2021" exhibition shall be held
at WATARI-UM, The Watari Museum of Contemporary Art

July 1 - September 5, 2021

Open Hours: 10:00-18:00

(Hama-rikyu Gardens: 9:00-17:00 / Takanawa Gateway Station: from first train to last train)
Opening hours are subject to change. For more details, please check our official website.

Venues: 9 venues in Tokyo, mainly around National Stadium

In front of Victor Studio / In front of United Nations University /
In front of the former "National Children's Castle" /

Yoyogi Park (near Panorama Grass Field) / Garden of kudan house /
Hama-rikyu Gardens (Site of Enryo-kan) /

Takanawa Gateway Station (inside the ticket gate) / and 2 other venues

Pavilion Creators:

Terunobu Fujimori / Kazuyo Sejima / Sou Fujimoto /
Akihisa Hirata / Junya Ishigami / Teppei Fujiwara /
Makoto Aida / Yayoi Kusama

Additional Creator: Daito Manabe + Rhizomatiks

Organizers: Tokyo Metropolitan Government,
Arts Council Tokyo (Tokyo Metropolitan Foundation for History and Culture),
and Executive Committee of Pavilion Tokyo 2021

Planning: WATARI-UM, The Watari Museum of Contemporary Art

official web site: <https://paviliontokyo.jp/>

Terunobu
Fujimori



Makoto
Aida



Junya
Ishigami



Teppei
Fujiwara



Akihisa
Hirata



Daito Manabe
+ Rhizomatiks

Kazuyo
Sejima



Yayoi
Kusama



Sou
Fujimoto



TOKYO
METROPOLITAN
GOVERNMENT



ARTS COUNCIL TOKYO

Planning:

WATARI-UM
The Watari Museum of Contemporary Art



● About PAVILION TOKYO 2021

PAVILION TOKYO 2021 is organized by the Tokyo Metropolitan Government, Arts Council Tokyo (Tokyo Metropolitan Foundation for History and Culture), and Executive Committee of Pavilion Tokyo 2021, as a part of Tokyo Tokyo FESTIVAL Special 13. This project is a world-first experiment to propose unrestrained and new urban landscape by installing architectures or objects at locations mainly around the National Stadium. Like a treasure hunt with map or during a walk, visitors can go around the pavilions in which the globally renowned architects and artists express one's hope for the future. Living Tokyo - Since some time ago, Tokyo has been undergoing a number of major area remodeling projects called redevelopment. Everywhere has been transformed into something convenient and clean, and we are receiving many benefits and enjoying a rich life there. On the other hand, as a graduate of Shibuya Aoyama Elementary School, I still have memories of Toden (Tokyo streetcar train) that used to run along Aoyama street proudly, the empty wide sky around the former "Kodomo no Shiro (Children's Castle)" where the Toden garage used to be, and the frightening memories of post-war sadness around Shibuya station. The city always had such memorable scenes in it. In fact, this project, PAVILION TOKYO 2021, aims to create a new story of the city. It is the summer 2021, a year in which the world is changing dramatically under the pandemic. In that year, the mysterious pavilions that could not possibly exist will appear in the city of Tokyo, and if the scenes shall reach even a small part of the minds of many people, this project will be a great success. During the 67 days of the exhibition, we hope you will experience the "living Tokyo."

Etsuko Watari (Chairman of Executive Committee of Pavilion Tokyo 2021)

● Venues

Terunobu Fujimori / Tea House "Go-an"

Venue: In front of Victor Studio

2-21-1, Jingumae, Shibuya-ku, Tokyo

Please look forward to the mysterious teahouse that will appear in front of the New National Stadium in July 2021.

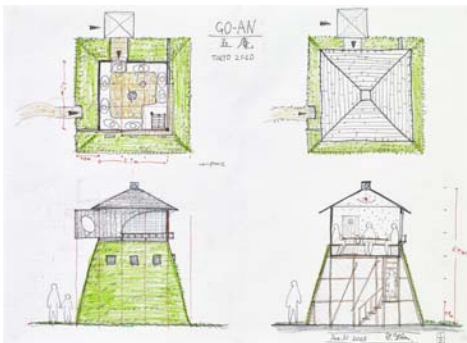

Tea House "Go-an" designed by Terunobu Fujimori

Note: Reservation is required for entry. More details will be announced later.

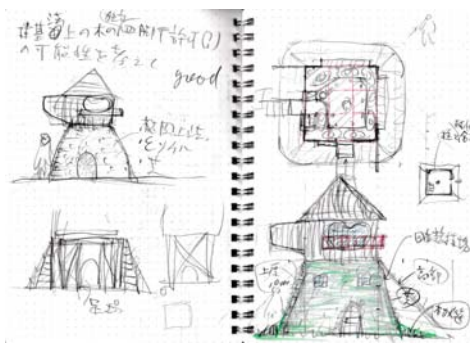

photo: Kazunori Harimoto



photo: Keizo Kioku

Documentary photography

Kazuyo Sejima / Suimei

Venue: Hama-rikyu Gardens (Site of Enryo-kan) **NEW**

Hama Rikyu-teien, Chuo-ku, Tokyo from <Otemon Entrance> of Hama-rikyu Gardens

The pavilion looks like curved water flowing smoothly through the garden, reflecting the sky on the surface of the water.



Suimei designed by Kazuyo Sejima



Note: Entry fee for Hama-rikyu Gardens is required. For details on how to enter the garden, please visit the Hamarikyuu Gardens official website.
[https://www.tokyo-park.or.jp/park/format/index028.html#googtrans\(en\)](https://www.tokyo-park.or.jp/park/format/index028.html#googtrans(en))

Sou Fujimoto / Cloud pavilion

1st Venue: **Yoyogi Park (near Panorama Grass Field) NEW**

Yoyogi-Kamizono-cho, Jinnan 2chome, Shibuya-ku, Tokyo

2nd Venue: **Takanawa Gateway Station (Inside the ticket gate) NEW**

2-1-220, Konan, Minato-ku, Tokyo

This is a pavilion of fluffy, floating clouds that appears in various parts of Tokyo.



Cloud pavilion designed by Sou Fujimoto

Akihisa Hirata / Global Bowl

Venue: **In front of United Nations University NEW**

5-53-70, Jingumae, Shibuya-ku, Tokyo

The large bowl envelops the various people passing through the city.

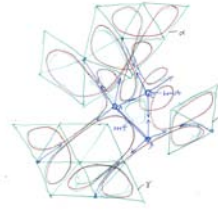
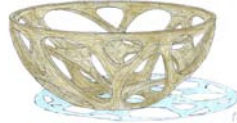
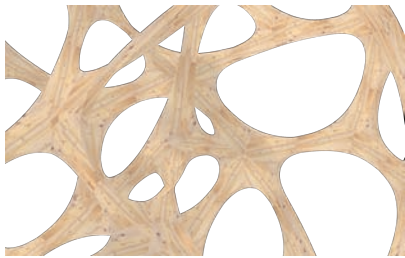

Global Bowl designed by Akihisa Hirata

Junya Ishigami / Kokage-gumo

Venue: **Garden of kudan house NEW**

1-15-9, Kudankita, Chiyoda-ku, Tokyo

Burnt cedar creates a mysterious landscape that is new, but seems to have been there for a long time.



Kokage-gumo designed by Junya Ishigami

Teppei Fujiwara / STREET GARDEN THEATER

Venue: In front of the former “National Children’s Castle” **NEW**

5-53-1, Jingumae, Shibuya-ku, Tokyo

The pavilion is like a garden in an alley, where people and plants are organically woven together.

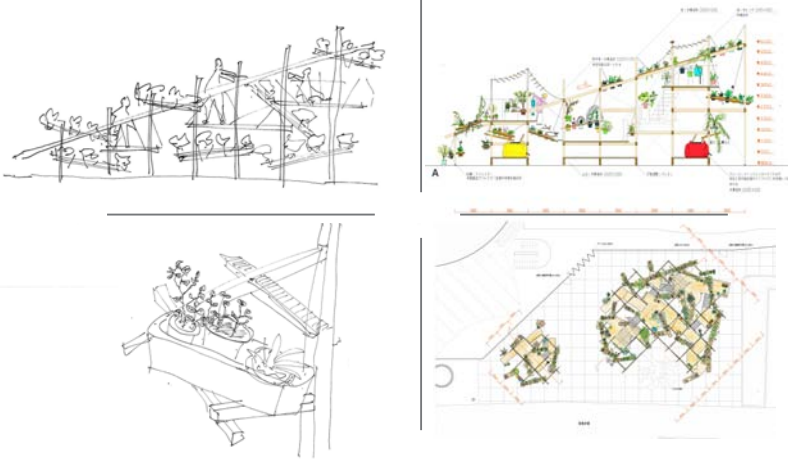

STREET GARDEN THEATER designed by Teppei Fujiwara

Makoto Aida / Tokyo Castle

Venue will be announced later

Two castles made of cardboard and blue tarp will appear.

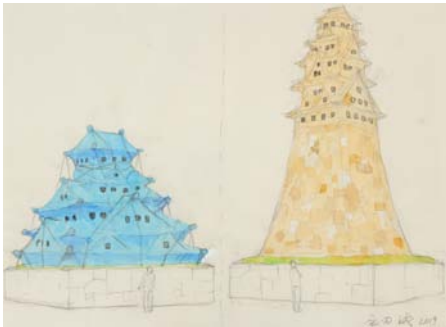

Tokyo Castle design by Makoto Aida

Photo by MIYAJIMA Kei (c) AIDA Makoto Courtesy of Mizuma Art Gallery

Documentary photography
Courtesy of Mizuma Art Gallery

Yayoi Kusama / The Obliteration Room

Venue will be announced later

Visitors can put colorful round stickers around a blank white room.



©YAYOI KUSAMA Yayoi Kusama / The obliteration room 2002–present

Collaboration between Yayoi Kusama and Queensland Art Gallery.

Commissioned Queensland Art Gallery. Gift of the artist through the Queensland Art Gallery Foundation 2012

Collection: Queensland Art Gallery, Australia Photograph: QAGOMA Photography

Cooperation: OTA FINE ARTS

【Additional Creator】

Daito Manabe + Rhizomatiks / “2020-2021” NEW

Venue: Open space in front of WATARI-UM

3-41-5, Jingumae, Shibuya-ku, Tokyo



Installation view, Sensing Streams 2021 - invisible, inaudible, 2021,
Ryuichi Sakamoto + Daito Manabe, 'seeing sound, hearing time',
courtesy M WOODS HUTONG, Beijing, 2021.
Photo by M WOODS photography team

Rhizomatiks:

Rhizomatiks pursues new possibilities in technology and expression and works mostly on experimental projects with a strong research and development focus. Engaged in almost all the stages of a project, from development of software and hardware to operations, they are working on R&D projects and creation, thinking about the relationship between humans and technology. Through collaboration works with artists, researchers, scientists and others, Rhizomatiks is bringing to the world cutting-edge expressions and research.

● Related project

【Free bottled water shall be distributed】

Free drinking water with original wrapping shall be distributed at some pavilions for a limited number (provided by Kakuichi Co.,Ltd).



【Pavilion Staffs】

During the exhibition, staff will be waiting for visitors at the venues to welcome and explain the details of the works.



Pavilion Staffs
Original T-shirt

- * The contents are subject to change.
- * There is no dedicated parking lot. Please refrain from coming to the venues by car as parking is limited in the neighborhood.
- * Please check the official website for information in case of inclement weather.
- * This event will be held implementing various COVID-19 measures to ensure maximum safety. We also request all visitors for the understanding and cooperation towards the precautionary measures. Please read and follow the instructions on the official website before your visit.

Please refer to the official website for access and viewing details.

<https://paviliontokyo.jp/>

● Exhibition

Related event

“PAVILION TOKYO 2021” exhibition at WATARI-UM, The Watari Museum of Contemporary Art

This exhibition shall be held, so that many people will know PAVILION TOKYO 2021 deeper, and enjoy visiting the Festival. The process of creating the pavilions, sketches, plans, models and the materials actually used shall be shown in the exhibition space. Movies of creators talking about their pavilion’s concept, will also be on display, along with a “special chronology table” showing their projects and works, documents, and movies produced by Kensaku Kakimoto.

June 19 – September 5, 2021

Closed on Mondays (except Aug. 9)

Open Hours: 11:00-19:00

Admission Fee: 1,000 yen

Free for those in high school or younger / Free for those who possess a physical disability

Note: Please refer to the PAVILION TOKYO 2021 official website (<https://paviliontokyo.jp/>) for information about how to enter and entrance restriction.

Participating Creators: Terunobu Fujimori / Kazuyo Sejima / Sou Fujimoto / Akihisa Hirata / Junya Ishigami / Teppei Fujiwara / Makoto Aida

Venue: WATARI-UM, The Watari Museum of Contemporary Art

150-0001 3-7-6, Jingumae, Shibuya-ku, Tokyo <http://www.watarium.co.jp/>

Contact about the exhibition: TEL: 03-3402-3001 (WATARI-UM, The Watari Museum of Contemporary Art)

<https://paviliontokyo.jp/>



Drawing for Tea House “Go-an” by Terunobu Fujimori

● Pavilion Creators

Terunobu
Fujimori



©Aiko Suzuki

Born in 1946. He got his PhD from the University of Tokyo. Now he is a director of Edo Tokyo Museum, a professor emeritus of the University of Tokyo, and a professor of Kogakuin University. After a long career as a researcher of modern architectural history and urban history, he debuted as an architect with Jinchokan Moriya Historical Museum in 1991, when he was 45 years old. He creates architectures in which nature and artifacts integrate. "Team Jomon Architecture," consisted of amateurs, sometimes helps to construct his work. His representative works are Tanpopo House (Dandelion House), Nira House (Leek House), Takasugi-an Tea House, and more. Recently he completed Mosaic-tile-Museum Tajimi and Kusayane and Douyane in La Collina Omi-Hachiman.

Kazuyo
Sejima



©Aiko Suzuki

Born in 1956. She got her master's degree from Japan Women's University. She established Kazuyo Sejima & Associates in 1987 and SANAA with Ryue Nishijima in 1995. She often uses acrylic and metal materials and makes space and people connecting loosely. Their representative works are 21st Century Museum of Contemporary Art, The New Museum of Contemporary Art in New York, Le Louvre-Lens, The Sumida Hokusai Museum (as Kazuyo Sejima & Associates) and her latest work Department of Art Science at Osaka University of Arts (as Kazuyo Sejima & Associates). In 2010, she was appointed director of architecture sector for the Venice Biennale as the first Japanese and female director. SANAA got many prizes including the AIJ Prize, the Golden Lion for the most remarkable work at the 12th Venice Biennale in 2004, the Pritzker Prize in 2010, and Sejima got Medal with Purple Ribbon in 2016.

Sou
Fujimoto



©Luca Gabino

Born in 1971. He started Sou Fujimoto Architects in 2000, soon after his graduation from the Faculty of Engineering at the University of Tokyo with a degree in architecture. His representative works are Musashino Art University Museum & Library, Serpentine Gallery Pavilion 2013 in London, L'Arbre Blanc in Montpellier, France, and his latest work SHIROIYA HOTEL. He was selected as a winner of several international competitions; the Ecole Polytechnique Learning Centre in Paris in 2015, and the Reinventing Paris project in Pershing/Porte Maillot in 2016. He is the Expo site design producer for the 2025 Japan International Exposition (Osaka/Kansai Expo).

Akihisa
Hirata



©CHIKASHI SUZUKI

Born in 1971. He got his master's degree from Kyoto University in 1997. After working for Toyo Ito & Associates, Architects, established his own office, Akihisa Hirata Architecture Office in 2005. Now he is a professor of Kyoto University. His representative works are Kotoriku, Art Museum & Library, Ota, and 9h nine hours. He is working on the exterior and rooftop design for the Jingumae 6-chome Urban Redevelopment Project, scheduled for completion in 2022. He got many prizes; the 19th JIA Newface Award, Elita Design Award (Photosynthesis), the Golden Lion at the 13th Venice Biennale in 2012 and more. He participated in an exhibition, Japanese Constellation in MoMA in 2016.

Junya
Ishigami



©Luca Gabino

Born in 1974. He acquired his master's degree in architecture and planning at Tokyo National University of Fine Arts and Music in 2000. After working in Kazuyo Sejima & Associates, he established his own firm in 2004: junya.ishigami+associates. He worked as a part time instructor at Tokyo University of Science, an associate professor at Tohoku University, and the Kenzo Tange Design Critic at the Harvard Graduate School of Design from 2014. His representative work is the Kanagawa Institute of Technology KAIT Workshop, Water Garden in Art Biotop Nasu, and Serpentine Pavilion 2019. He got many prizes; AIJ Prize for Architectural Design in 2009, and the Golden Lion for Best Project at the 12th Venice Architecture Biennale in 2010. He held a large-scale exhibition "Junya Ishigami, Freeing Architecture" in Fondation Cartier pour l'art contemporain in 2018.

Tepppei
Fujiwara



©YAYOI KUSAMA

Born in 1975. He got his master degree from the Yokohama National University. Before he established his own firm, FUJIWALABO in 2009, he had worked in Kengo Kuma & Associates from 2001 and designed many projects in more than twenty cities in the world; Tiffany Ginza, Sanlitun Soho in Beijing, Asakusa Culture Tourist Information Center, FRAC Marseille, and more. He also acts as a director of a NPO Drifters International from 2010 and an assistant professor of Y-GSA at Yokohama National University from 2012. His practices cross the border between architecture and other fields including art, theater and urban scale matters. His representative works are KURKKU FIELDS, Nasushiobara Community Center Kururu, Inamura House and Gardens, and venue design for Reborn-Art Festival 2017.

Aida
Makoto



©YAYOI KUSAMA

Born in 1965. He got his master's degree in Fine Arts from the Tokyo National University of Fine Arts. He often uses pretty young girls, war and office workers as his motifs. He comes and goes freely between society and history, current time and pre-modern period, west and east and presents an unexpected contrast and a caustic criticism. He gains overwhelming support from people in all generation. He has a wide range of works not only paintings, but also sculpture, performance, films, novels and manga. His representative exhibitions are "Bye Bye Kitty!!! Between Heaven and Hell in Contemporary Japanese Art" (Japan Society, New York, 2011), "Monument for Nothing" (Mori Art Museum, Tokyo, 2012), "GROUND NO PLAN" (Aoyama Crystal Building, Tokyo, 2018).

Yayoi
Kusama



Born in 1929. She has experienced visions and auditory hallucinations from an early age, and began to draw polka dots and net patterns as motifs. In 1957, she moved to United States by herself and discovered an artistic philosophy of self-obliteration through obsessive repetition and multiplication of a single motif, and established herself as an avantgarde artist by developing a diverse range of works including net paintings, soft sculptures, environmental sculptures using mirrors and electric lights, and happenings. In addition to her artistic activities, she has also published a number of novels and poems. Her representative works include Infinity Net, Dots Obsession, Pumpkin, and My Eternal Soul. She is one of the most important Japanese artists, continuing to work energetically in and outside Japan today. In 2017, She held a large retrospective exhibition "My Eternal Soul" (The National Art Center, Tokyo) and in the same year, the Yayoi Kusama Museum opened in Shinjuku, Tokyo.

【Creator Interviews】

Interviews of Pavilion Creators about their thoughts on their pavilion and Tokyo, are available on the website of TOTO Publishing.

(https://jp.toto.com/publishing/pav_tokyo2020/index.htm)

【SNS】



<https://www.facebook.com/pavilionskyo>



<https://www.instagram.com/pavilionskyo/>



<https://twitter.com/pavilionskyo>

【Contact】

Executive Committee of Pavilion Tokyo 2021 (Staff:Sugiyama)

TEL: 03-3402-3001/FAX: 03-3405-7714 E-mail: info@pavilionskyo.jp

Website:<https://pavilionskyo.jp>

Executive Committee of Pavilion Tokyo 2021

Honorary Chairman: Kengo Kuma (Architect)

Chairman: Etsuko Watari (Director of WATARI-UM, The Watari Museum of Contemporary Art)

Members: Ken Hasebe (Mayor of Shibuya Ward), Kenichi Yoshizumi (Mayor of Shinbuku Ward), Masaaki Takei (Mayor of Minato Ward), Isoya Shinji (President of Fukui Prefectural University and landscape architect) and Seiichiro Yonekura (Economist)

Chairman of Production Committee: Koichi Watari (CEO of WATARI-UM, The Watari Museum of Contemporary Art)

Art Director: Hiroshi Ito (groovisions)

Event Management: earth garden / en Ltd.

Creator Interview: TOTO Publishing

Lawyer: Tasuku Mizuno (CITY LIGHTS LAW)

Auditor: Makoto Sakaki (Mutsuo Yamagishi Tax Accountant Office)

Special sponsors: OBAYASHI CORPORATION / JINS HOLDINGS Inc.

Sponsors: TOHO LEO Corporation / New Constructor's Network Co.,LTD / Cartier / Avex Business Development Inc. / FORM GIVING INC. / Victor Entertainment

Cart support / Providing water: Kakuichi Co.,Ltd

Security support: Goto Security Services Company Ltd

About Tokyo Tokyo FESTIVAL

Tokyo Tokyo FESTIVAL is an initiative that unfolds a variety of cultural programs in the run-up to the Olympic and Paralympic Games held in Tokyo, promoting its appeal as a city of arts and culture.

About Tokyo Tokyo FESTIVAL Special 13

The Tokyo Metropolitan Government and Arts Council Tokyo sought a wide range of creative and innovative ideas from the public for projects that would become the core of the cultural programs for the Tokyo Tokyo FESTIVAL. From a total of 2,436 project proposals submitted from within Japan and overseas, 13 were selected for implementation. The 13 projects are collectively named "Tokyo Tokyo FESTIVAL Special 13," and are being implemented in sequence.

official web site:<https://tff-koubo.jp>